

Hollow Ram, Single acting, Spring return hydraulic jack

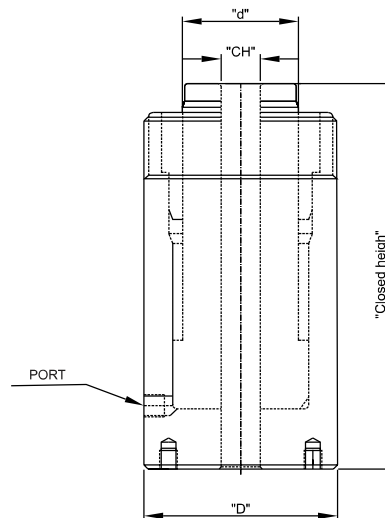

Features:

- Multipurpose jacks.
- Hydraulic puller with mechanical fixture, for pull or push usage.
- Base mounting & collar threads are optional
- Maintenance fabrication, sugar Ind. & etc.
- HardChrome plating to avoid corrosion score mark.
- Used in vertical and horizontal directions.
- Maximum working pressure @700 BAR.

Model	Capacity	Stroke	Close Height	C'Hole Dia	Cylinder OD (D)	Cylinder ID (d)	Ram OD	Weight (Approx)
	ton	mm	mm	mm	mm	mm	mm	kg
MHS	10	50	165	20	75	60	50	4.6
MHS	10	100	215	20	75	60	50	6
MHS	20	50	170	27	105	85	75	10.5
MHS	20	100	270	27	105	85	75	16
MHS	30	50	195	33	115	95	80	13
MHS	30	100	245	33	115	95	80	16
MHS	50	50	230	42	150	125	100	25
MHS	50	100	255	42	150	125	100	27
MHS	60	50	245	54	165	135	110	32
MHS	60	100	270	54	165	135	110	35
MHS	100	50	270	77	215	180	150	58
MHS	100	100	295	77	215	180	150	62

Note:-

- Higher capacity customized solutions on request.
- Plating or painting on demand.